



**Beaver Dam/Littlefield Fire District**  
**Board of Directors**  
 630 N. Highway 91, P.O. Box 579  
 Beaver Dam, AZ. 86432  
 Telephone: (928) 347-4457 Fax: (928) 347-4458  
[www.beaverdam-littlefieldfire.org](http://www.beaverdam-littlefieldfire.org)



**RESOLUTION 2021-15**

**A Resolution of the Beaver Dam/Littlefield Fire District Governing Board of Directors Authorizing the Amendment of the Beaver Dam/Littlefield Fire District’s Boundaries to include land within Mohave County which is adjacent to the boundaries of the Beaver Dam/Littlefield Fire District after written request by the property owner in Accordance with A.R.S. §48-262(I).**

*Whereas*, on July 28, 2021, Leo and Shirley Wilson, Owner(s) of record for the referenced property in the attached exhibits should be annexed into the Beaver Dam/Littlefield Fire District Boundaries as noted in **Exhibit A** and **Exhibit B**; and

*Whereas*, the subject property is located within Mohave County and is adjacent to the boundaries of the Beaver Dam/Littlefield Fire District as shown on the Plat Maps as noted in **Exhibits C and D**; and

*Whereas*, the Beaver Dam/Littlefield Fire District Governing Board of Directors has determined that the inclusion of the subject property within the boundaries of the Beaver Dam/Littlefield Fire District will benefit the Beaver Dam/Littlefield Fire District and the Property Owner(s).

*Be it resolved* by the Beaver Dam/Littlefield Fire District Board of Directors to the following:

Section 1: The boundaries of the Beaver Dam/Littlefield Fire District are hereby amended to include the property described as set forth on the attached **Exhibits A, B, C, and D**.

Passed and adopted at a duly noticed meeting of the Beaver Dam/Littlefield Fire District Governing Board of Directors held this 19<sup>th</sup> day of August, 2021.

Dan R. Reber  
 Dan Reber, (Acting) Board Chairman  
 Beaver Dam/Littlefield Fire District

8-19-2021  
 Date

AS ATTESTED TO:

Thomas M. Oliver  
 Thomas M. Oliver, Board Clerk (Acting)  
 Beaver Dam/Littlefield Fire District  
 Kevin L. Smith

8/19/21  
 Date

REQUEST FOR CONSIDERATION / INCLUSION  
AND ACCEPTANCE INTO THE  
BEAVER DAM / LITTLEFIELD FIRE DISTRICT BOUNDRIES

Leo + Shirley Wilson

Name(s) of Property Owner(s)/Homeowner(s)

1741 Northern Drive

Property Address, (City, County, State)

P.O. Box 1535, Mesquite, NV 89024

Mailing Address (If different than above)

Home: — Cell: 801-910-6158 801-230-0278  
Any other numbers you may be reached

Phone Number(s)

Email address(s) Shirley W@webguyinternet.com

The following information can be found on your tax statement(s) and match exactly:

Parcel ID 402-14-100

List the parcel number as stated on your tax bill (One sheet for each parcel please)

T39N R16W Sec 2 the NE4 SE4 NW4 of Sec 2

List the legal Description as noted on your tax bill

I/we do request that the Beaver Dam/Littlefield Fire District Governing Board of Directors consider the above parcel(s) be annexed into the Beaver Dam/Littlefield Fire District.

I/we do hereby to the best of our knowledge that the above information is true and correct and conforms with A.R.S. §48-262 (1).

Leo Wilson Shirley Wilson  
Signature(s)

Dated the 28 of July 2021  
Day Month Year



# MOHAVE COUNTY 2020 PROPERTY TAX STATEMENT

Cindy Landa Cox, MBA, Treasurer  
(928) 753-0737



WILSON LEO D & SHIRLEY F  
3408 E 7635 S  
SALT LAKE CITY, UT 84121-5446

Assessor Description: Section: 2 Township: 39N Range: 16W T39N  
R16W SEC 2 THE NE4 SE4 NW4 OF SEC 2 NOT INCLUDING THE  
EAST 35' DESCRIBED AS : BEG AT THE SE CORNER OF SAID NE4

### THANK YOU FOR YOUR PROMPT PAYMENT

TREASURY ACCOUNT #	PARCEL #	TAX AREA	TAX RATE PER \$100 ASSESSED VALUE				
R0270624	40214100	902	9.4543				
ASSESSMENT		VALUE IN DOLLARS	LEGAL CLASS ASSMT%	ASSESSED VALUE	EXEMPT AMOUNT	TAX RATE	TAX
TAXABLE PROPERTY VALUE		5,852	15.0	878	0	9.4543	83.00
TAXABLE PERSONAL PROP VALUE		0	0.0	0	0	8.9543	0.00
TAXABLE PROPERTY VALUE TOTAL		5,852		878	0		83.00
2019 TAXES	2020 TAXES	TAXING AUTHORITY	PHONE #S		% of TAX		
0.00	16.68	MOHAVE COUNTY	(928) 753-0735		20.10%		
0.00	3.89	STATE SCHOOL TAX EQUALIZATION	(928) 753-5678		4.69%		
0.00	35.02	LITTLEFIELD/MT TRUMBEL SD #9	(928) 347-5574		42.19%		
0.00	11.31	MOHAVE COMMUNITY COLLEGE	(928) 757-4331		13.63%		
0.00	0.88	FIRE DIST ASSIST FUND	(928) 753-0735		1.06%		
0.00	2.38	MOHAVE COUNTY LIBRARY DISTRICT	(928) 692-5763		2.87%		
0.00	4.40	MOHAVE COUNTY FLOOD CONTROL DI	(928) 757-0925		5.30%		
0.00	0.53	MO CO TV CID	(928) 753-0729		0.64%		
0.00	7.91	SD#9 CLASS B BONDS	(928) 347-5574		9.53%		
\$0.00	\$83.00	TOTAL			100%		

2020 TAX SUMMARY	
For the period of January 1 - December 31	
Total Tax	83.00
Special District	
LESS: State Aid	
LESS: Prepay	
TOTAL DUE	83.00

**PAYABLE UPON RECEIPT**

**SEE PAYMENT STUB FOR DUE DATE**

Mail your check with the corresponding payment stub to:

MOHAVE COUNTY TREASURE  
PO BOX 712  
KINGMAN, AZ 86402

### ADDITIONAL INFORMATION

#### MORE WAYS TO PAY

**In Person:** Check, Money Order, or Cashier's Check. Cash is accepted in person, during office hours. Your canceled check is your receipt.

**Credit Card or Electronic Payment**

(processing fees will apply):

Call: 1-855-814-6451 or

Visit us Online: [www.mohavecounty.us](http://www.mohavecounty.us)

**Using Your Banks Online Banking "Bill Pay" Option:**

Set up a SEPARATE bill pay payee for EACH PARCEL

Instructions are available on our website:

[www.mohavecounty.us](http://www.mohavecounty.us)

Select: Online Bill Pay Instructions

#### ANSWERS TO YOUR QUESTIONS

**Mohave County Treasurer's Website:**

- Copies of tax statements, payment receipts and payment history

- Visit us online: [www.mohavecounty.us](http://www.mohavecounty.us)

**Mohave County Assessor's Website:**

- Online Address Changes

- Valuation, legal classification, and ownership/ address records

Call: 1-928-753-0703 or

Visit the Assessor online: [www.mohavecounty.us](http://www.mohavecounty.us)



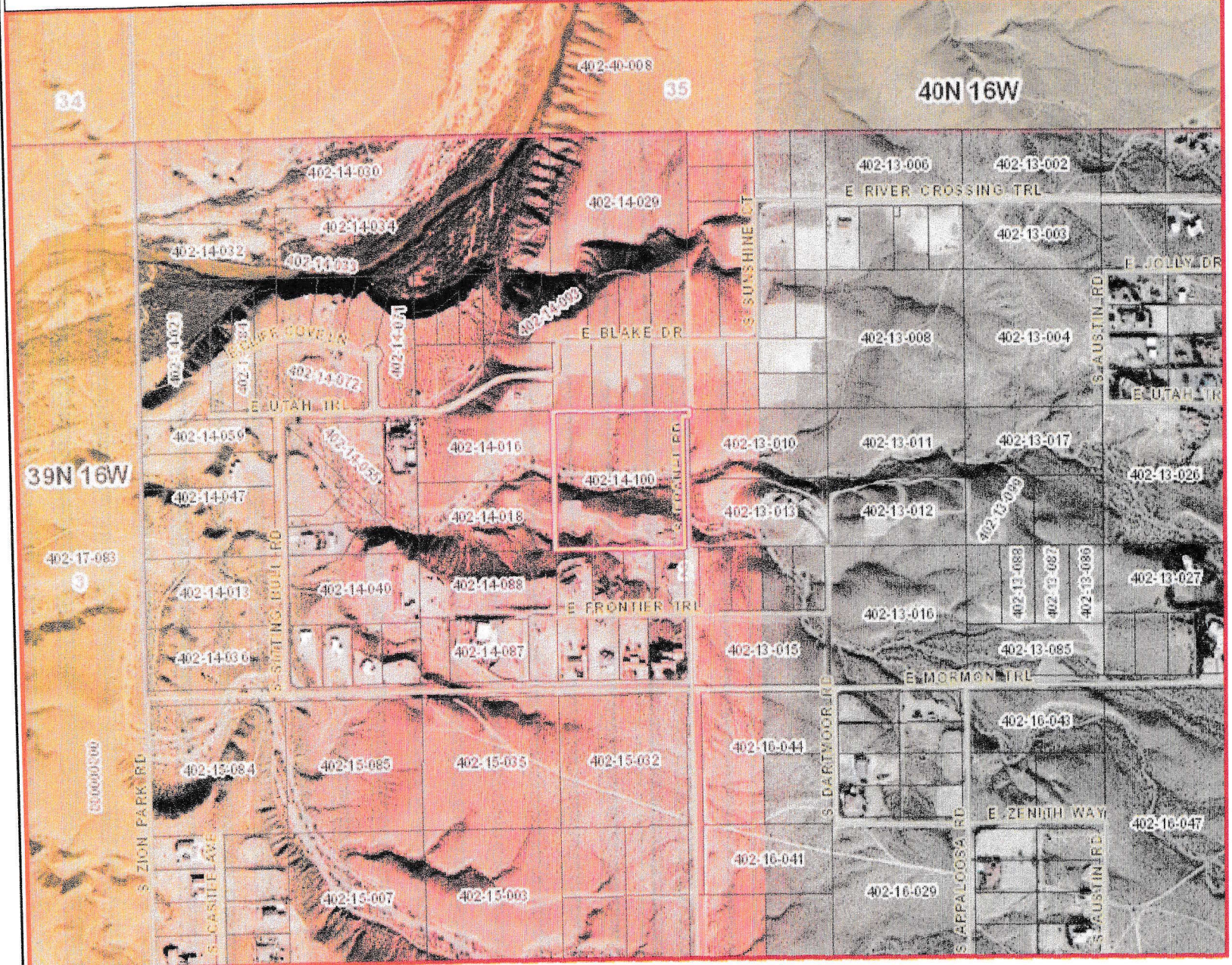
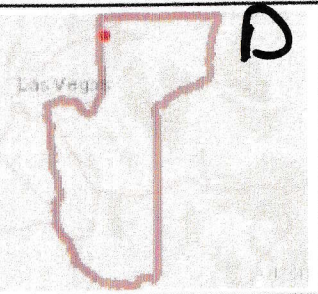

**Legend**

- ADOT Mileposts
- COUNTY Mileposts
- Sign Post Exists
- Calculated Measure
- Highways
- Main Arterials
- Collectors
- Local
- Railroad
- City Limits (>1:120K)
- County Boundary
- Surrounding Counties
- Township/Range
- Section

**Surface Management**

- Bureau of Land Management
- Bureau of Reclamation
- County
- Indian Lands
- Local or State Parks
- Military
- National Parks Service
- Other
- Private
- State
- State Wildlife Area
- US Forest Service
- US Fish & Wildlife Service

1: 10,409

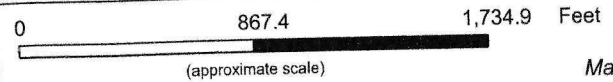

Map Created: 8/14/2021

This map is a user generated static output from the Mohave County Interactive Map Viewer and is for general reference only. Data layers that appear on this map may or may not be accurate, current, or otherwise reliable. THIS MAP IS NOT TO BE USED FOR NAVIGATION, AS A LEGAL DOCUMENT, FOR PROPERTY DESCRIPTIONS, OR DETERMINATION OF LEGAL TITLE, AND SHOULD NEVER BE SUBSTITUTED FOR SURVEY OR DEED INFORMATION. The user agrees to comply with the Limitation of Use, and Assumption of Risk as stated in the full disclaimer at <https://gis.mohave.gov>

**Notes:**